

RIMINI MARINA STAZIONE

ACTUAL STATE PICTURES / DIGITAL REPRESENTATION WITH MINOR
INTERVENTION











POSSIBLE INTERVENTION

RIMINI MARINA STAZIONE

SYMBOLOLOGY

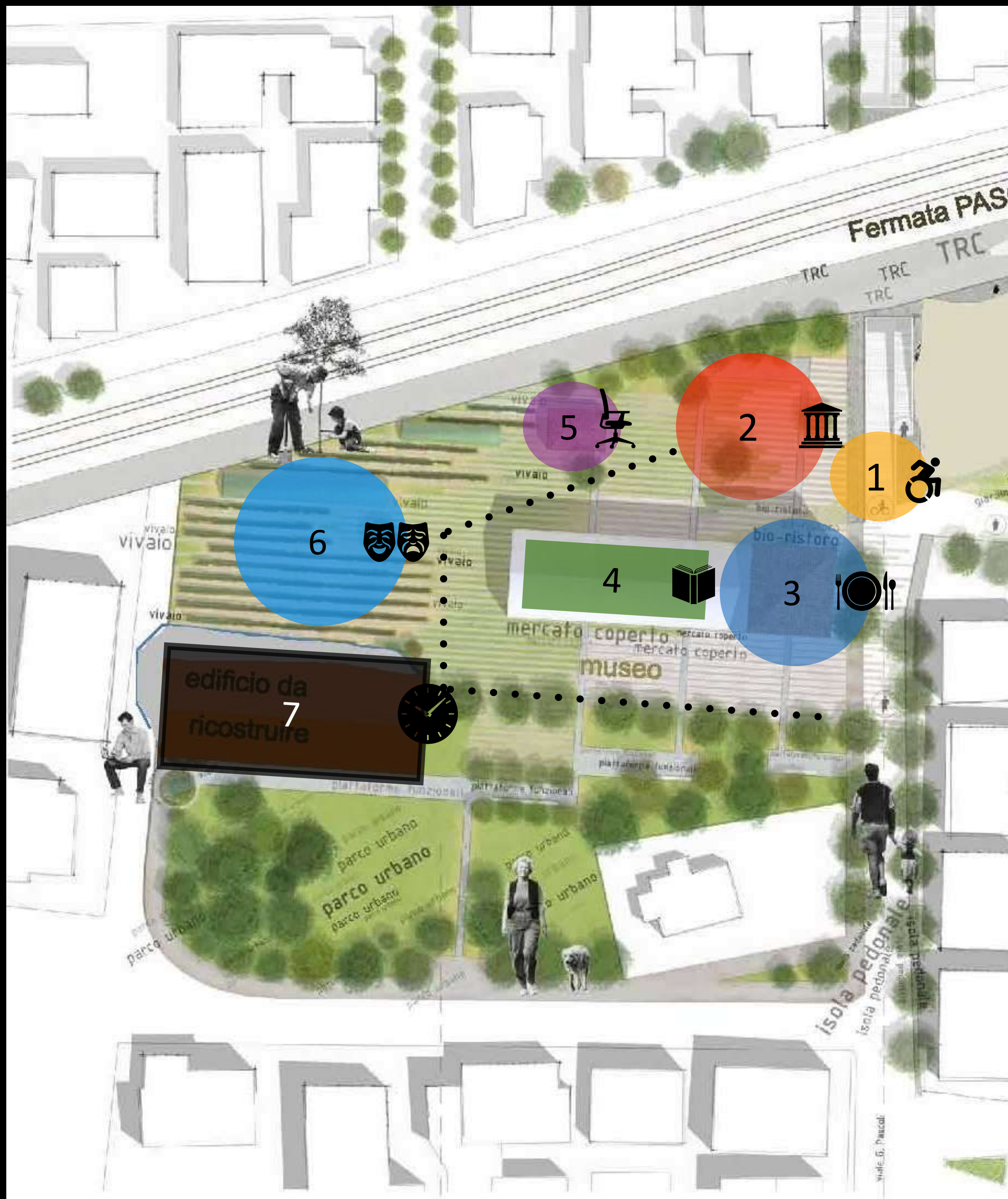

1. Integration of the passageway for the TRC with the entrance of the complex, guaranteeing **universal accessibility**.
2. **Open air museum circuit** (dotted line), at the style of “colines urbaines”, with views in strategic points integrating photographs and reminiscences of the old station, overlooking the newly constructed TRC. Example: <https://bit.ly/3duMEGY> (Mechanical garden, Paris.)
3. **Snack bar**. With the integration of the original design of the station, use of materials in tone, as well as optimal and unblocked views to the outside.
4. **Exposition hall**. Can be used with cultural purposes, such as conferences, expositions, book signings and concerts. Taking into account the material usage, “completion” and retrofitting of lacking parts. Examples: <https://bit.ly/2WPcQ9I> (Burgos railway station, Spain) and <https://bit.ly/2Ux7psM> (The ruin, Russia).
5. **Offices**. This space can host the offices for the administrative purposes of the facilities.
6. **Amphitheater**. This open space can be used for plays, movie expositions and art installations.
7. **Ephemeral building**. This space can be considered to create a lightweight, uncomplicated, ephemeral structure or pavilion, that can withstand time but at a low price point with high flexibility.

